

Please read carefully before use and keep it properly.  
We supply warranty within 12 months after purchase date for all qualified machines.

## ◇ Operation

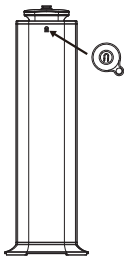

① Use the magnetic lock key to get close to the magnetic lock identification, unlock atomization head.

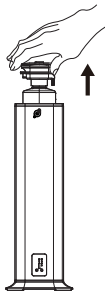

② Take out the atomization head

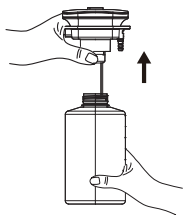

③ Turn out the essential oil bottle, refill the essential oil and put it back.

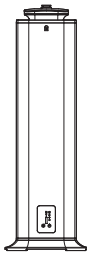

④ Connect the power, start the machine.

## ◇ Packing

Scent diffuser x1, bottle x1, power adapter x1, atomization core x1, magnetic lock key x2, user manual x1, certificate x1.

## ◇ Key Operation Instructions

### 1 LED indicator

- ① Air pump
- ② Essential oil bottle
- ③ fan
- ④ Screen touch lock
- ⑤ Bluetooth
- ⑥ Power and air pump on/off

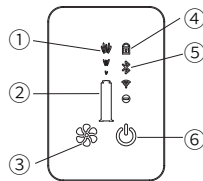

### 2 Touch Screen Operation

• Connect the power and press the power key for 3 seconds to turn it on/off.

• After starting up, the device will automatically run for 5 seconds. Touch the key gently to start/stop the device.

When the diffuser is running, the air pump running status indicator light (blue) continues to flash; The color of the indicator light of the essential oil bottle and the air pump reflect the essential oil level, as shown in the following table:

Essential Oil Level	Text Display	Indicator Light
50~100%	high	Blue
20~50%	med	Yellow
0<20%	low	Red

When the device is paused, the power key is red. When powered off, all indicators are off.

• Touch the fan key to start/stop the fan. When the fan is started, the indicator light is blue. After the fan is stopped, the indicator light is red.

## ◇ Bluetooth Setting Steps

### 1 App download ways:

Scan the QR code to download the APP, or search for "Scent Tech" in the App Store or Google Play. Install Scent Tech on your phone and allow the app gets the permission to use your phone. Click the Bluetooth icon to enter the device management page:



APP download

1) My Devices: The connected devices are displayed. The "My Device" column is a historical paired device. Click "My Device" to enter the device work interface for device management.

2) Available devices: When there are other available devices nearby, their device names will be displayed, click the corresponding device name to connect the device.

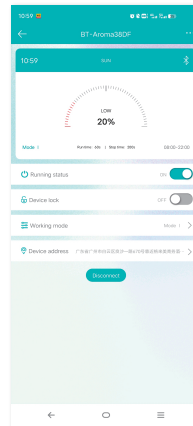
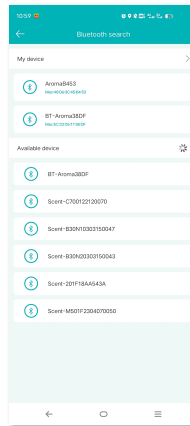

## 2 APP Home

Indicator light: When the device does not connect, the Bluetooth indicator light is always on; When the device is connecting to Bluetooth, the Bluetooth light flashes blue; When there is operation on the APP, the device emits a "beep" sound response.

1) Device status bar:

① Display the local time and current working mode details automatically read by the system. Clicking "Disconnect" will cancel the connection of the currently matched device and exit the current device management interface.

② Rename: You can customize the device name.

③ Working state: One click to turn on or off the working state of the device.

④ Fan: One click to turn on or off the fan.

⑤ Touch key lock: lock/unlock the touch screen lock. After locking, touch operation on the device will be prohibited (reset or power off and restart to unlock).

⑥ Working mode: After connect the Bluetooth, you can set the working mode of the device through the APP: five groups timing, consumption setting and week combination can be customized and set separately. When a certain working mode is on, the column is displayed

in bright colour, and when the working state is closed, it is displayed in gray.

#### ◆ Replace the atomization core

The atomization head include: oil bottle,oil suction pipe,filter,atomization core. Take down the oil bottle, pull out the suction pipe, remove the atomization core,then insert the new atomizing core into the main body of the atomization head, and align the oil suction pipe with the small hole in the atomization core and press it tightly.



#### ◆ Equipment maintenance

If the diffuser is not used for a long time, 95% industrial alcohol should be added into the refined oil bottle to clean the nozzle and other parts inside the diffuser. Tip: Maintain the diffuser with 95% industrial alcohol at least every 1-2 months.

Specific operation: add 95% industrial alcohol into the empty bottle, turn on the diffuser and run for 10-15 minutes after, then turn off the diffuser and pour the alcohol, then screw back the bottle to machine.

#### ◆ Product parameters

• Size: 185×185×606mm	• Weight: 3kg
• Voltage: DC 12V	• Capacity: 800ml
• Power: 14W	• Coverage: 2000-3000m <sup>3</sup>

#### ◆ Warranty

1.The Warranty is suitable for new machine but not resell or second hand products.

2.Within 12 months after purchase date, Warranty is offered for all qualified machines. During warranty,we will offer repair services and the free parts but not include essential oil.

3.The warranty card & purchase Invoice are needed if after service required. Please contact with us within warranty if any problems.

4.The following is not for free warranty service:

- ① Damage & problems caused by Accidents & Fire.
- ② Not use properly and wrong operation.
- ③ If repaired by not professional person and make some parts damaged.
- ④ Damaged during transportation.
- ⑤ Without our warranty card.
- ⑥ Without proper cleaning for a long time
- ⑦ The machine work time out.
- ⑧ Machines & Parts not from us.
- ⑨ Machines not gotten from official channels.
- ⑩ Send the machines back without permit from manufacturer.

#### ◆ Notice

- 1.Please carefully read the Instruction before installation, and keep the User manual to check if need at anytime
- 2.Please make sure the machine upright ,no leaking and no down; or may damage the device and parts
- 3.Please do not use the broken power wire and make sure the power supply is suitable for the machine, or may cause fire .
- 4.Please do not open the machine by yourself, If problems, please contact us promptly !

## VERTICAL SMART SCENT DIFFUSER



### USER MANUAL

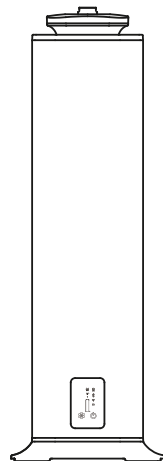

Please read the manual carefully and keep it properly before use

